



### Materials used

<b>Face plate</b>	stainless steel AISI 304, thickness 0,8mm	
<b>Mount plate</b>	stainless steel AISI 430, thickness 0,8mm	
<b>Indicator lens</b>	Polycarbonate	
<b>Push button</b>	<b>Body</b>	Polyamide 6
	<b>Fixing locks</b>	ABS

### Available finishes

	Silver brushed(standard)		Silver mirror
	Gold brushed		Gold mirror
	Bronze brushed		Bronze mirror
	Champagne brushed		Champagne mirror
	Black brushed		Black mirror

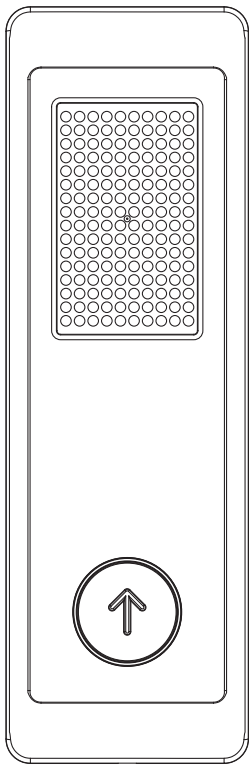

Front view



Side view

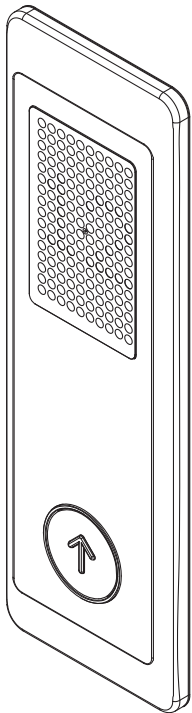

Isometric front view

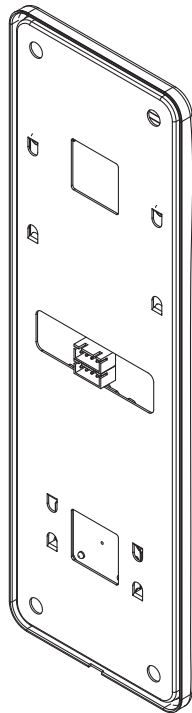

Isometric back view

**Materials**

<b>Faceplate</b>	brushed AISI 304L stainless steel
<b>Mountplate</b>	AISI 430 stainless steel
<b>Button body</b>	polyamide
<b>Display Lens</b>	-

**Technical details**

<b>push plate</b>	304 Grade Brushed plate
<b>chassis</b>	Translucent plastic
<b>chassis lock</b>	ABS plastic
<b>PCB</b>	high quality PCB

**Dimensions**

<b>Width</b>	80mm
<b>Height</b>	250mm
<b>Depth</b>	9,9mm

## Components

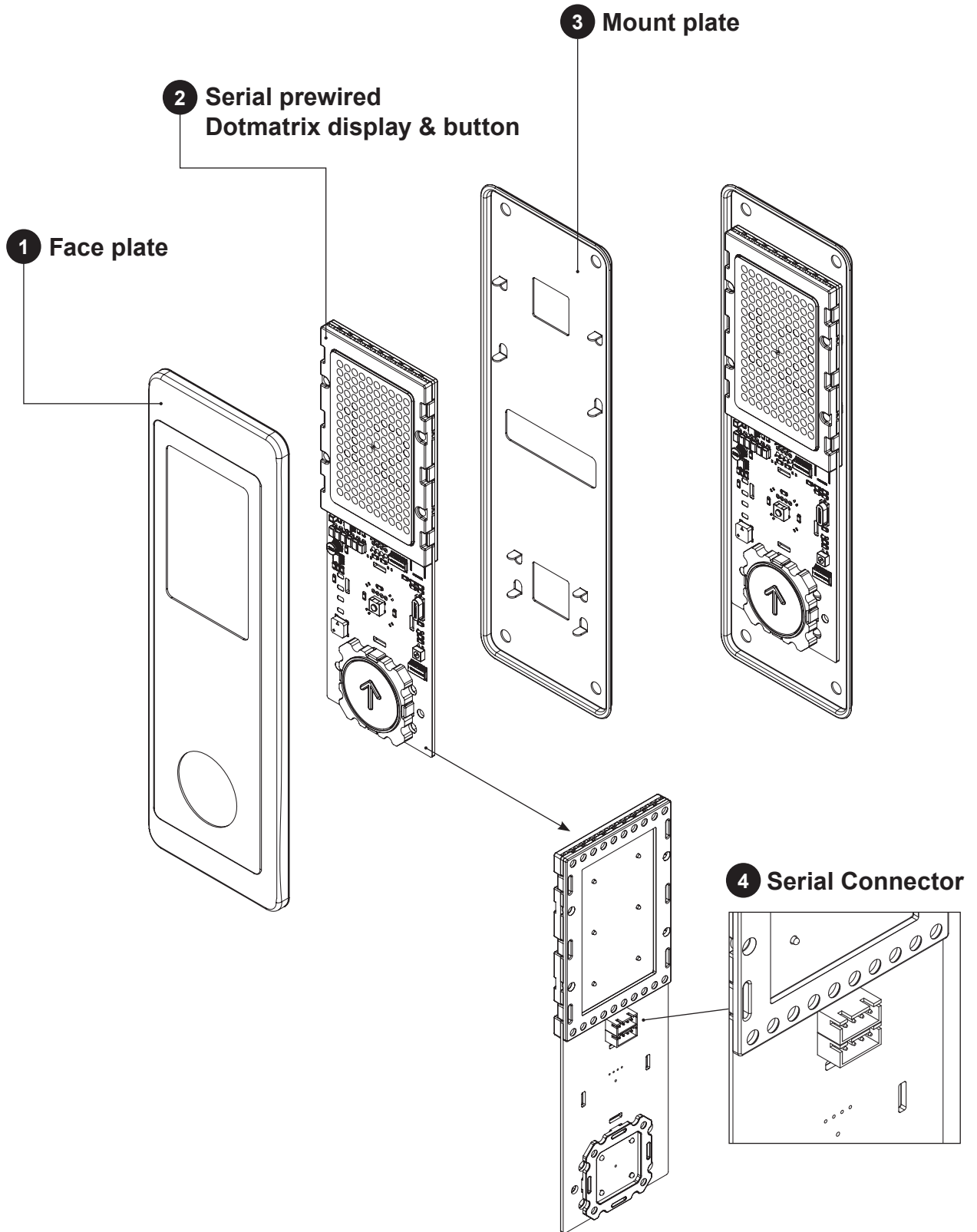

### Serial prewired connection block diagram

